

Kawasaki

Assembly Instructions

Model:	ER650G/H, EX650J/K
Description:	Slider
Part Number:	99994-0797
Flat Rate Time(Hr):	ER650G/H: 0.1 EX650J/K: 0.7

Before you begin, read through these instructions and check that all parts are present. Please note that Kawasaki cannot assume any responsibility for damage resulting from incorrect installation.

Kawasaki recommends that all genuine accessories should be fitted by an authorized Kawasaki dealer.

The following symbols indicate the information for proper installation and operation in this instruction.

NOTE : NOTE indicates information that may help or guide you in the operation or service of the vehicle.

● Indicates a procedural step or work to be done.

○ Indicates a procedural sub-step or how to do the work of the procedural step it follows. It also precedes the text of a NOTE.

Refer to the following Service Manual for detailed procedures.

ER650G/H: P/No.: 99924-1516-01

EX650J/K: P/No.: 99924-1517-01

Parts List				
No.	Component Name	Part No.	Qty	Remark
1	Guard	55020-1997	2	
2	Nut	92210-1505	2	
3	O-ring	670B3026	2	
4	Bolt	92154-1014	4	M5 × 16 mm (0.6 in.)
5	Cover	14093-0350	1	Left
6	Cover	14093-0351	1	Right
7	Nut	92015-1757	4	5 mm (0.2 in.)
8	Bolt	120CA0822	2	M8 × 22 mm (0.9 in.)
9	Washer	92200-0807	2	
10	Bolt	120CA0840	1	M8 × 40 mm (1.6 in.)
11	Collar	92152-2237	1	
12	Bolt	92151-1277	2	M6 × 10 mm (0.4 in.)
13	Collar	92152-2236	2	

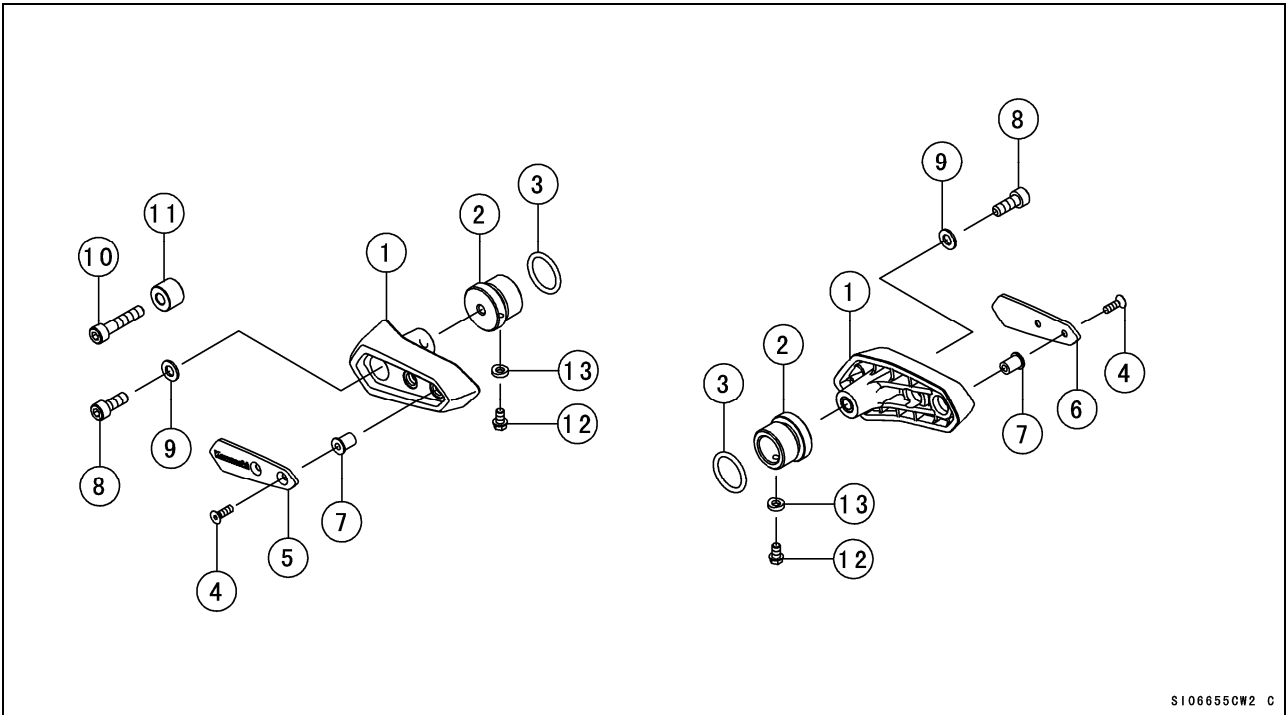

S106655CW2 C

NOTE

- ER650G/H models do not use the bolt [10] and collar [11].
- EX650J/K models do not use the bolt [8] (only on left side).

Installation Instructions

- For EX650J/K models, remove the middle fairings (Refer to the Service Manual).

- Install the O-rings [3] to the nuts [2].

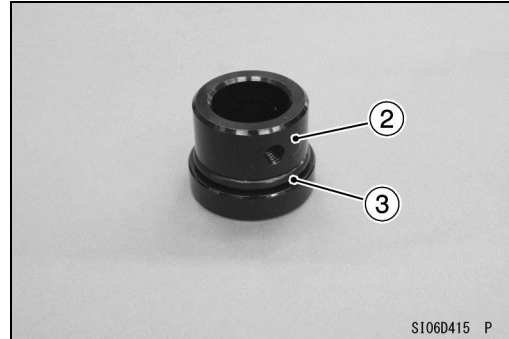

- Install the nuts assy [A] (both sides).

- Align the threads holes [B] of the nut to the holes [C] of the frame pipe (both sides).

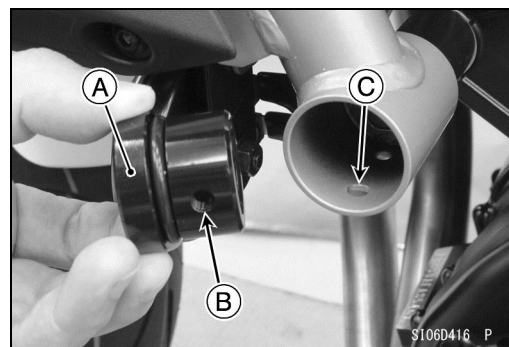

- Install the collars [13] to the bolts [12] so that the curve side [A] faces upward (both sides).

- Apply liquid thread locker (Loctite 263) to the threads of the bolts [12], and tighten them (both sides).

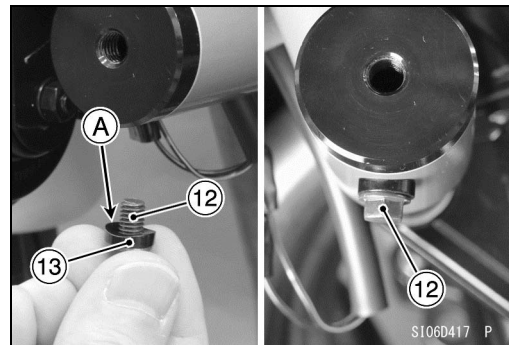

- Install the nuts [7] to guards [1] (both sides).

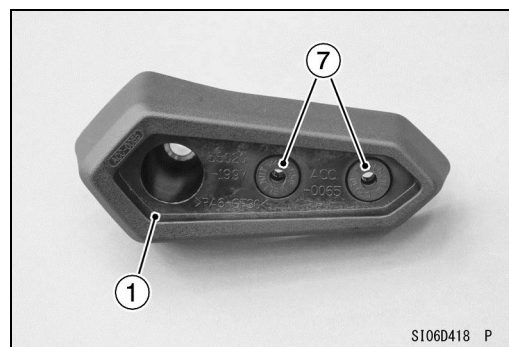

ER650G/H Models

- Install (both sides):
Guard Assy [A]
Washers [9]
- Hold the guards horizontally, and tighten the bolts [8] (both sides).

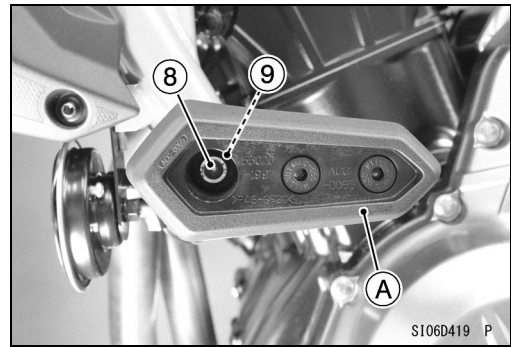

EX650J/K Models

- Install the middle fairings (Refer to the Service Manual).
- Install the collar [11] (only on left side).
- Install (both sides):
Guard Assy [A]
Washers [9]
- Hold the guards horizontally, and tighten the bolts [10] (both sides).

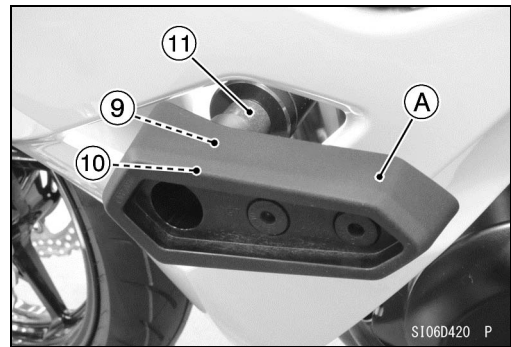

- Install the covers [5] [6], and tighten the bolts [4] (both sides).

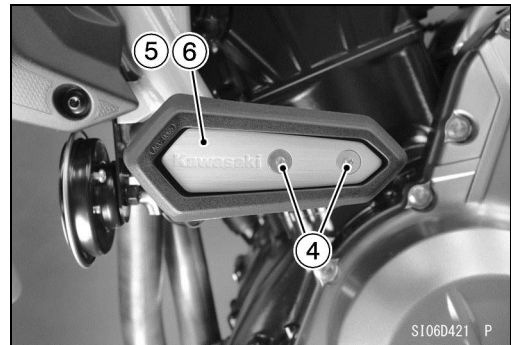

Basic Torque for General Fasteners

The table below, relating tightening torque to thread diameter, lists the basic torque for the bolts and nuts. Use this table for only the bolts and nuts which do not require a specific torque value. All of the values are for use with dry solvent-cleaned threads.

Threads dia. (mm)	Torque		
	N·m	kgf·m	ft·lb
5	3.4 ~ 4.9	0.35 ~ 0.50	30 ~ 43 in·lb
6	5.9 ~ 7.8	0.60 ~ 0.80	52 ~ 69 in·lb
8	14 ~ 19	1.4 ~ 1.9	10 ~ 13.5
10	25 ~ 34	2.6 ~ 3.5	19 ~ 25
12	44 ~ 61	4.5 ~ 6.2	33 ~ 45
14	73 ~ 98	7.4 ~ 10.0	54 ~ 72
16	115 ~ 155	11.5 ~ 16.0	83 ~ 115
18	165 ~ 225	17.0 ~ 23.0	125 ~ 165
20	225 ~ 325	23.0 ~ 33.0	165 ~ 240

Check tightness of all fasteners in regular interval. Retighten loose fasteners.